

Control Stations & Switches: Components for Increased Safety Enclosures

FU40 Series: Fuse Carrier

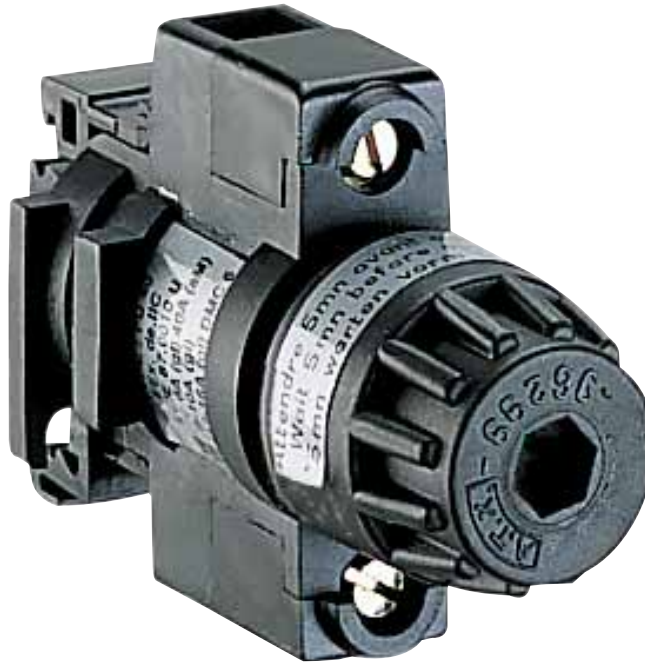

Fuse Carrier
FU40

Compliances:

ATEX - IEC:



Zone 1 & 2	ATEX	II 2 G	IEC	CE
Ex de IIC				

Ratings:

Cartridge Fuse gG	Cartridge Fuse aM	Voltage		
16A maximum	40A maximum	Up to 500 V		

Service Temperature:

-40°C to +120°C				
-----------------	--	--	--	--

Control Stations & Switches: Components for Increased Safety Enclosures

FU40 Series: Fuse Carrier

Zone 1 & 2

⊕ II 2 G

ATEX / IEC

Applications:

- Useful as back-up fuse protection or as main fuse protection for hazardous locations.
- Can be fitted inside increased safety Ex e enclosures.

Features:

- For 14 x 51 mm cylindrical cartridge fuse 16A gG Max. and 40 A aM Max.
- Adaptor which clips onto EN 50 022 and EN 50 035 rail.
- Connection via 2 x 10 mm² terminals.

Standard Material of Fixtures:

- Polyamide.



Fuse Carrier
FU40

Ordering Information:

Weight (kg)	Volume (dm ³)	Fuse Size (mm)	Catalog Number	Old Catalog Number	Pack
0.1	0.4	14 x 51	FU40	096299	1

Compliances:

Hazardous Area	Gas
Certification Type	FU40
Zones	1-2
Conforming to ATEX 94/9/CE	0081⊕ II 2 G
Symbol of Protection ATEX	Ex de IIC
Symbol of Protection IEC	
T Rating	N.A.
Ambient Temperature	N.A.
Service Temperature	-40°C to +120°C
Declaration of Conformity	5C207
ATEX Certificate	LCIE 02 ATEX 0003U
IEC Certificate	LCIE Ex 02.021U
Other Certifications	-
Index of Protection	-
Impact Resistance (shock)	-

Standards:

Ex Standards	EN / IEC 60079-0; 60079-1; 60079-7
Product Standards	EN / IEC 60947-1; 60947-3
EMC Standards	-
Other Standards	EN / IEC 60529 (IP)

Dimensions (mm):

Fuse carrier

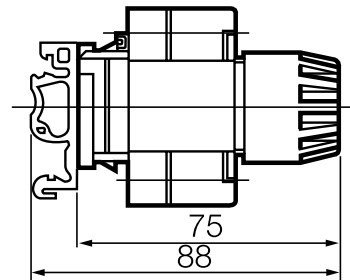
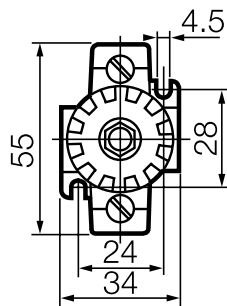

FU40