

D Series Aluminum Control Stations

Flameproof

Zone 1 and 2 – 21 and 22
Gas (G) and Dust (D)

Applications

- Local control stations for use in hazardous areas.
- Control of electrical equipment at power plants, chemical and petrochemical plants, petroleum- refineries, pulp and paper processing plants and various industrial applications.

Features

- 1 and 2 Function Ex d IIC:
 - Supplied with actuators, contact blocks and pilot lights.
 - TS35 rail mounted contact blocks.
 - Threaded flameproof joint.
 - Connection: 2 x 2.5 mm² maximum.
 - Internal earth: 2 x 4 mm².
 - External ground: M5
 - 1 x M20 or M25 threaded entry at bottom.
 - Cable glands and plugs to be ordered separately.
- 2 and 3 Function Exd IIB:
 - Supplied with actuators and rail mounting pilot lights and contact blocks.
 - Flanged flameproof joint.
 - Yellow laminated plastic legend plate with black lettering.
 - Connection : 2 x 2.5 mm² maximum.
 - Internal earth: 2 x 4 mm² .
 - External earth: M6 screw.
 - 2 x M20 threaded entries at the bottom.
 - Cable glands and plugs to be ordered separately.

Standard Materials

- Box: gray painted marine grade aluminum alloy

Options

- For other configurations, see pre-drilled control stations or consult factory.

Certifications and Compliances

◆ATEX Certification

• Certification Type BR1d

- Gas, Zones 1 and 2
 - Conforming to ATEX 94/9/CE: Ⓢ II 2 G
 - Type of Protection: Ex d IIC
 - Temperature class: T6 for Ta = +40 °C, T5 for Ta = +55 °C
- Dust, Zones 21 and 22
 - Conforming to ATEX 94/9/CE: Ⓢ II 2 D
 - Type of Protection: Ex tD A21
 - Surface Temperature: T95 °C
- Ambient Temperature: -40 °C to +55 °C
- CE Declaration of Conformity: 20530
- ATEX Certificate: LCIE 02 ATEX 6056

• Certification Type CF2D

- Gas, Zones 1 and 2
 - Conforming to ATEX 94/9/CE: Ⓢ II 2 G
 - Type of Protection: Ex d IIB
 - Temperature class: T6 for Ta ≤ +40 °C, T5 for +40 °C < Ta ≤ +55 °C

- Dust, Zones 21 and 22

- Conforming to ATEX 94/9/CE: Ⓢ II 2 D
- Type of Protection: Ex tD A21
- Surface Temperature: T95 °C
- Ambient Temperature: -40 °C to +55 °C
- CE Declaration of Conformity: 50254
- ATEX Certificate: LCIE 03 ATEX 6061X
- Index of Protection according EN/IEC 60529: IP66
- Impact Resistance (shock): IK10
- Internal Volume: ≤ 2 dm³ (2 liters)

◆EURASEC Certification

- EURASEC RU C-FR. ГБ 05.B.00911

◆Others Certification ①

- INMETRO Certificate: BVC 11.0482

1 Function



2 Function



2 Function



3 Function







① Inmetro certification available on special request only. Contact your local sales for more information.

D Series Aluminum Control Stations

Flameproof

Zone 1 and 2 – 21 and 22
Gas (G) and Dust (D)

Type	Description/Function	Bottom Entries	Weight kg	Volume dm ³	Catalog Number
1 Function Ex d IIC Control Stations					
Spring Return Push Button					
	BR1d 1x black spring return push button with 1NO + 1NC momentary contacts	1 x M20	1.0	3.75	DA1W1T101
	BR1d 1x black spring return push button with 1NO + 1NC momentary contacts	1 x M25	1.0	3.75	DA1W3T101
Mushroom Head Push Button					
	BR1d 1x red mushroom head push-pull with 1NO + 1NC maintained contacts Padlockable in both positions	1 x M20	1.2	3.75	DA1W1T102
	BR1d 1x red mushroom head push-pull with 1NO + 1NC maintained contacts Padlockable in both positions	1 x M25	1.2	3.75	DA1W3T102
	BR1d Red mushroom head key release with 1NO + 1NC maintained contact Unlocked with key (MS1)	1 x M20	1.2	3.75	DA1W1T104
	BR1d Red mushroom head key release with 1NO + 1NC maintained contact Unlocked with key (MS1)	1 x M25	1.2	3.75	DA1W3T104
Time Delayed Push Button 230 V 50/60 Hz					
	BR1d 1x time delayed black impulse push button adjustable from 25s to 15mn For 1000 W incandescent or 400 W fluorescent max.	1 x M20	1.2	3.75	DA1W1T103
	BR1d 1x time delayed black impulse push button adjustable from 25 s to 15 mn For 1000 W incandescent or 400 W fluorescent max.	1 x M25	1.2	3.75	DA1W3T103
Twin Push Buttons					
	BR1d 1x green spring return 'I' push button with 1NO momentary contact 1x red spring return 'O' push button with 1NC momentary contact	1 x M20	1.2	3.75	DA1W1T201
	BR1d 1x green spring return 'I' push button with 1NO momentary contact 1x red spring return 'O' push button with 1NC momentary contact	1 x M25	1.2	3.75	DA1W3T201
2 Function Ex d IIB Control Stations					
Twin Push Buttons					
	CF2D 1x green spring return 'I' push button with 1NO momentary contact 1x red spring return 'O' push button with 1NC momentary contact	2 x M20	2.5	7.00	DA4W2T201
	CF2D 1x green spring return 'I' push button with 1NO momentary contact 1x red mushroom head push-pull with 1NO+1NC maintained contacts	2 x M20	2.5	7.00	DA4W2T202



Controls

CONTROL STATIONS AND SWITCHES - FLAMEPROOF

D Series Aluminum Control Stations

Flameproof

Zone 1 and 2 – 21 and 22
Gas (G) and Dust (D)

Type	Description/Function	Bottom Entries	Weight kg	Volume dm ³	Catalog Number
3 Function Ex d IIB Control Stations					
Pilot Light and Twin Push Buttons					
 CF2D	1x red/green LED light 85 to 264 Vac 1x green spring return 'I' push button with 1NO momentary contact 1x red spring return '0' push button with 1NC momentary contact	2 x M20	3.3	9.00	DA5W2T301
Ammeter and Twin Push Buttons					
CF2D	1x ammeter 48 x 48 CT1A 3 x FLC 0-1-3A 1x green spring return 'I' push button with 1NO momentary contact 1x red spring return '0' push button with 1NC momentary contact	2 x M20	3.3	9.00	DA5W2T302
Ex d IIC Limit Switch ①					
Limit Switch <i>Stainless steel roller control perpendicular for surface fixing. 1/4 turn fixing (may be modified by end user).</i>					
 BR1d	1x roller plunger - travel 7 mm max. - Force 22 newtons with 1NO+1NC momentary contacts	1 x M20	1.0	4.60	DA1W1L001
BR1d	1x roller plunger - travel 7 mm max. - Force 22 newtons with 1NO+1NC momentary contacts	1 x M25	1.0	4.60	DA1W3L001

Technical Data			
Contact Block		LED Pilot Light	
Insulation Voltage (Ui)	500 V	Rated Voltage	85 Vac to 264 Vac, 50/60 Hz
Switching Capacity		Rating	5-15 mA
AC 15	4 A/115 V, 4 A/230 V, 2 A/500 V	Max. Power	0.33 W
DC 13	3 A/24 V, 1.7 A/42 V, 1.2 A/60 V, 0.8 A/110 V, 0.3 A/220 V	Operation life	Average 100,000 Hours at +25 °C
Terminal connections	0.75 to 2.5 mm ²		
Operation life	>5,000,000 Operations		
Light Switch			
Insulation Voltage (Ui)	500 V		
Switching Capacity			
AC 15	450 W/48 V, 900 W/110 V, 1900 W/230 V		
DC 13	100 W/48 V, 100 W/110 V, 95 W/230 V		
Terminal connections	0.75 to 2.5 mm ²		
Operation life	> 1,000,000 Operations		

D Series Aluminum Control Stations

Flameproof

Zone 1 and 2 – 21 and 22
Gas (G) and Dust (D)

Electrical Diagrams

NO Contact Block



NC Contact Block



LED Pilot Light



Time Delayed Push Button

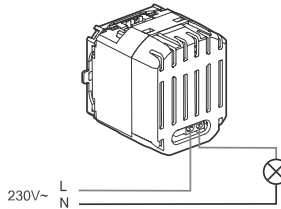

Dimensions in Millimeters

1 Function

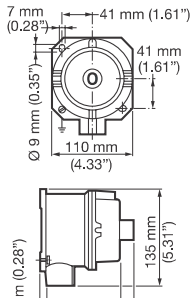

1 Function Emergency Stop

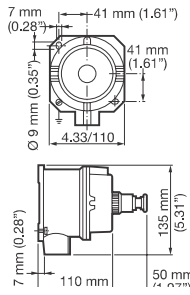

2 Functions

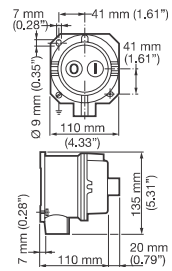

Limit Switch

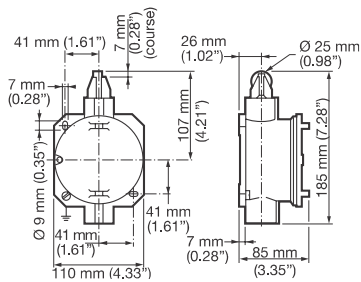

2 Functions

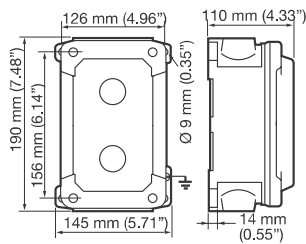

3 Functions

